







SPECIAL SCREWS

HIGH CHEMICAL RESISTANCE

SCREWS SPECIAL MATERIALS			
MATERIAL	MODEL REF.	FEATURES	APPLICATIONS
Hastelloy	SNSH-C22 	<ul style="list-style-type: none"> • Resistant to wet chlorine gas • Resistant to hypochlorite and chlorine dioxide • Corrosion resistance against oxidizing and reducing acids and salts <p>Cleanroom wash and cleanroom packing are completed For aquatic applications that use sea and salt water</p>	<ul style="list-style-type: none"> • FPD PRODUCTION EQUIPMENT • SEMICONDUCTOR DEVICES • PRINTED • CIRCUIT BOARD ETCHING DEVICES • METALLIC SURFACE TREATMENT EQUIPMENT AND FACILITIES • CHEMICAL PLANTS
Hastelloy	SNSH-C276 	<ul style="list-style-type: none"> • Corrosion resistance against oxidizing and reducing salts <p>Cleanroom wash and cleanroom packing are completed</p>	
PTFE (Teflon)	SPT 	<ul style="list-style-type: none"> • Chemical resistance • Abrasion resistance • Heat resistance • High incombustibility • Electrical properties 	
MAT21	SNSMT 	<ul style="list-style-type: none"> • Resistance in both oxidizing and reducing environments • Better corrosion resistance than Hastelloy <p>Cleanroom wash and cleanroom packing are completed</p>	
Silicon Carbide	SICX-SX 	<ul style="list-style-type: none"> • Excellent chemical resistance • Heat resistance 	
Tántalo	SNSTA 	<ul style="list-style-type: none"> • Corrosion resistance to strong acids such as sulfuric acid • Resistant to aqua regia • High specific gravity <p>Cleanroom wash and cleanroom packing are completed</p>	

SPECIAL SCREWS HIGH CHEMICAL RESISTANCE

HEAD SCREW PROTECTION

COVER CAP		HEAD PTFE COATING
PTFE cover cap SCAP-PT 	Ceramic cover cap SCAP-CE 	SNHS-HTF 

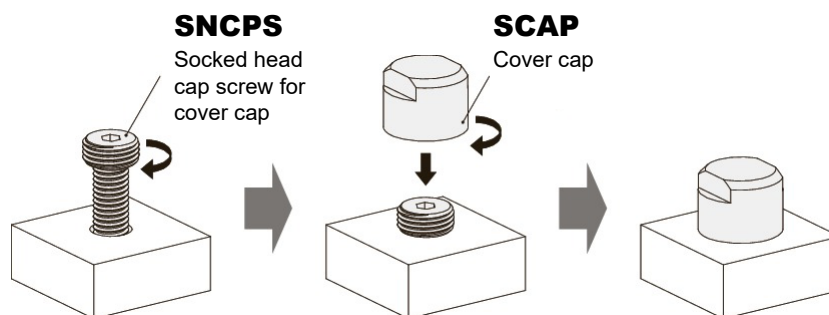

Solve Problems with Screws

Engineering
Support



Development of
the optimal design

Fast Shipment



Extensive Inventory

Customize



Flexible Customization
Available

